

DOUILLES A SOUDER CD

DOUILLES TARAUEDES

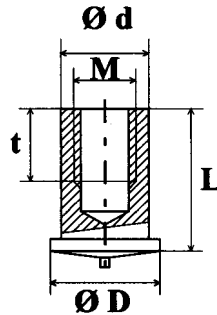

D	D	ISO métrique	6	8	10	12	15	20	25	30
5	7	M3	*	*	*	*	*	*	*	*
6	7.5	M4		*	*	*	*	*	*	*
7.1	9	M5			*	*	*	*	*	*

COSSES A SOUDER

Cosse double :

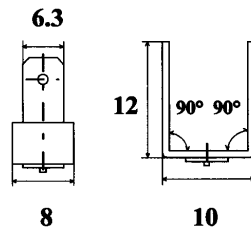

Cosse simple :

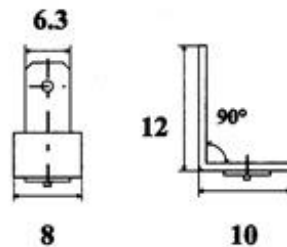

MATIERE STANDARD :
Acier cuivré
Acier inox
Aluminium
Laiton

Autres dimensions : nous consulter